

LARGE ALUMINUM ELECTROLYTIC CAPACITORS

HU Snap-in Terminal Type, Long Life Series

- Long life guaranteed for 5000 hours load life at 105 °C
- Voltage range of 200~450V
- Suited for use in high reliability equipment



| Item | Characteristics | | | | | | |
|---|--|------|------|-----------------------------------|------|------|------|
| Operating temperature range | WV ≤ 400 : -40 ~ +105 °C, WV = 450 : -25 ~ +105 °C | | | | | | |
| Capacitance tolerance | ±20% at 120Hz, 20 °C | | | | | | |
| Leakage current max. | $I = 3\sqrt{CV}$ (μA) (after 5 minutes) | | | | | | |
| Dissipation factor max. (at 120Hz, 20 °C) | Capacitance > 1000 μF : tan δ increases by 0.01 for each 1000 μF from below value. | | | | | | |
| | WV | 200 | 250 | 315 | 350 | 400 | 450 |
| | tan δ | 0.15 | 0.15 | 0.15 | 0.15 | 0.15 | 0.20 |
| Load life (after application of the rated voltage for 5000 hours at 105 °C) | Leakage current | | | Less than specified value | | | |
| | Capacitance change | | | Within ±25% of initial value | | | |
| | tan δ | | | Less than 250% of specified value | | | |
| Shelf life (at 105 °C) | After 1000 hours no load test, leakage current, capacitance and tan δ are same as load life value. | | | | | | |

DRAWING

Unit : mm

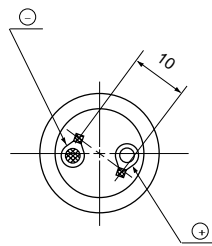
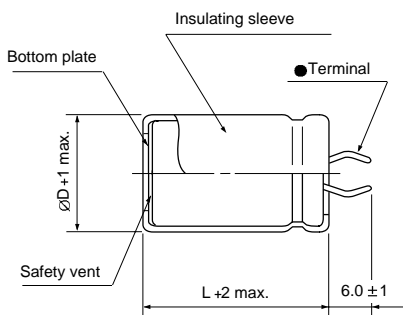

PC Board Mounting Holes

Terminal

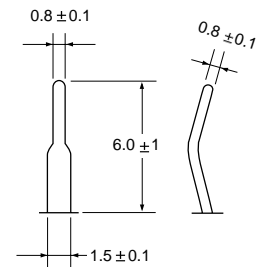

DIMENSIONS & MAXIMUM PERMISSIBLE RIPPLE CURRENT

| μF \ WV | 200 | | 250 | | 315 | | 350 | | 400 | | 450 | |
|---------|-----------|------|-----------|------|-----------|------|-----------|------|-----------|------|-----------|------|
| 47 | | | | | | | | | | | 22 × 30 | 0.29 |
| 56 | | | | | | | | | 22 × 25 | 0.40 | 25.4 × 25 | 0.32 |
| 68 | | | | | | | | | 25.4 × 25 | 0.48 | 25.4 × 30 | 0.38 |
| 82 | | | | | 22 × 25 | 0.48 | 22 × 25 | 0.48 | 25.4 × 25 | 0.53 | 30 × 30 | 0.45 |
| 100 | | | | | 22 × 30 | 0.57 | 25.4 × 25 | 0.59 | 25.4 × 30 | 0.62 | 30 × 30 | 0.50 |
| 120 | | | | | 25.4 × 25 | 0.64 | 25.4 × 30 | 0.68 | 30 × 25 | 0.70 | 30 × 30 | 0.55 |
| 150 | | | 22 × 25 | 0.68 | 30 × 25 | 0.78 | 25.4 × 30 | 0.76 | 30 × 30 | 0.83 | 35 × 30 | 0.66 |
| 180 | | | 22 × 30 | 0.79 | 30 × 25 | 0.86 | 25.4 × 35 | 0.88 | 35 × 30 | 0.98 | 35 × 35 | 0.76 |
| 220 | 22 × 25 | 0.82 | 25.4 × 30 | 0.96 | 30 × 30 | 1.00 | 30 × 35 | 1.06 | 35 × 30 | 1.08 | 35 × 40 | 0.88 |
| 270 | 25.4 × 25 | 1.00 | 25.4 × 35 | 1.13 | 35 × 30 | 1.20 | 30 × 40 | 1.23 | 35 × 35 | 1.26 | 35 × 45 | 1.01 |
| 330 | 25.4 × 30 | 1.18 | 30 × 30 | 1.28 | 35 × 30 | 1.33 | 35 × 35 | 1.40 | 35 × 40 | 1.46 | 35 × 50 | 1.17 |
| 390 | 25.4 × 35 | 1.35 | 30 × 35 | 1.47 | 35 × 35 | 1.52 | 35 × 40 | 1.59 | 35 × 45 | 1.66 | | |
| 470 | 25.4 × 40 | 1.56 | 35 × 30 | 1.65 | 35 × 40 | 1.74 | 35 × 45 | 1.82 | 35 × 50 | 1.89 | | |
| 560 | 30 × 35 | 1.76 | 35 × 35 | 1.89 | 35 × 45 | 1.98 | 35 × 50 | 2.06 | | | | |
| 680 | 30 × 40 | 2.03 | 35 × 40 | 2.18 | 35 × 50 | 2.27 | | | | | | |
| 820 | 35 × 35 | 2.29 | 35 × 45 | 2.50 | | | | | | | | |
| 1000 | 35 × 35 | 2.53 | 35 × 50 | 2.87 | | | | | | | | |
| 1200 | 35 × 40 | 2.69 | | | | | | | | | | |
| 1500 | 35 × 50 | 3.25 | | | | | | | | | | |

Ripple current (A rms) at 105 °C, 120Hz
Case size ØD × L (mm)